

AMARR 2502/ 2512/ 2522

Previously Models 2500/2500i

ENTRE//MATIC

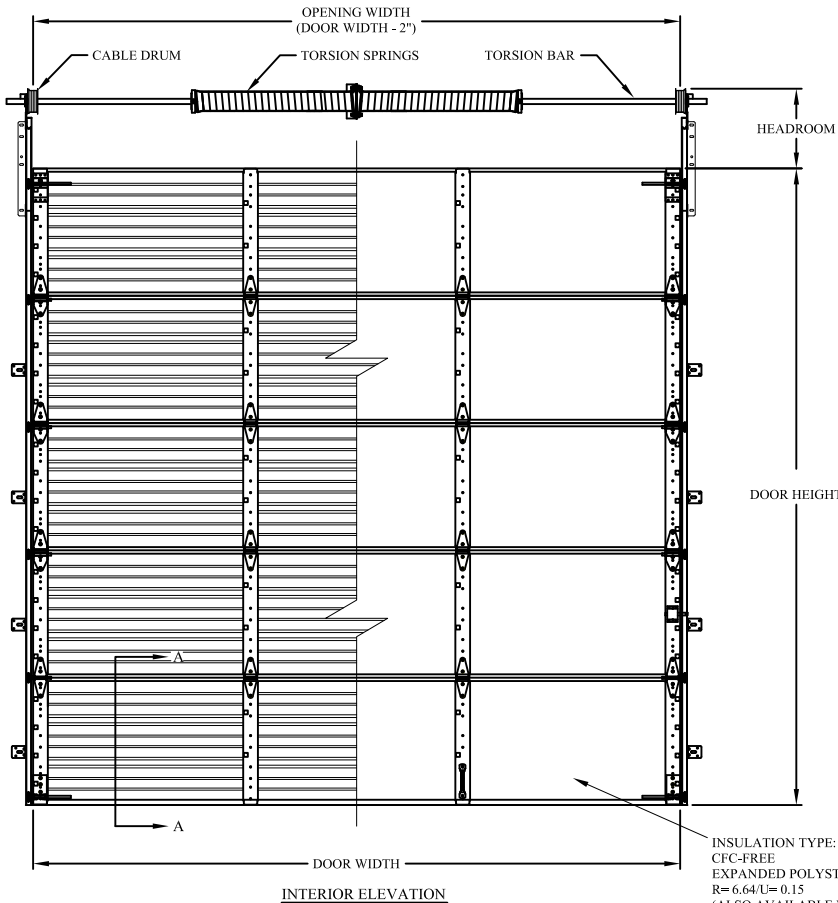

INTERIOR ELEVATION

INSULATION TYPE: HAIRCELL
CFC-FREE
EXPANDED POLYSTYRENE
R= 6.64/U= 0.15
(ALSO AVAILABLE WITH
25ga STEEL BACKER)

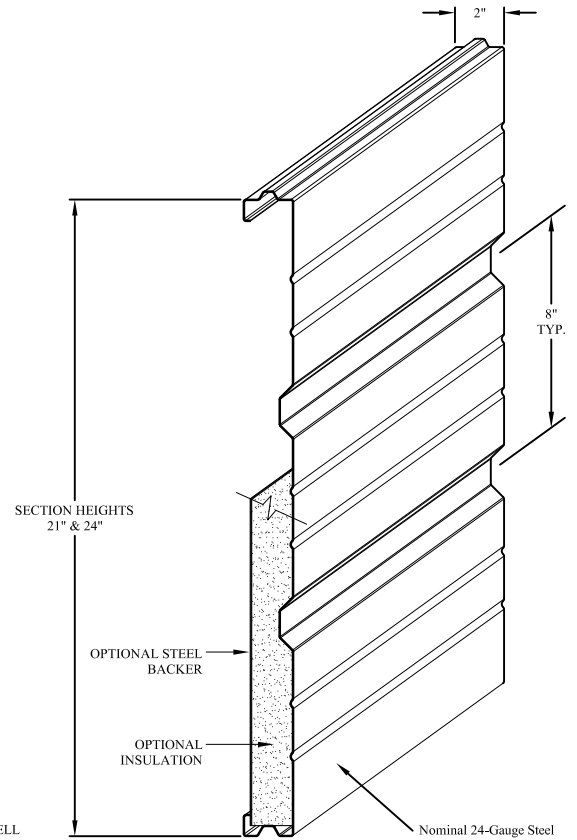

ISOMETRIC PROFILE

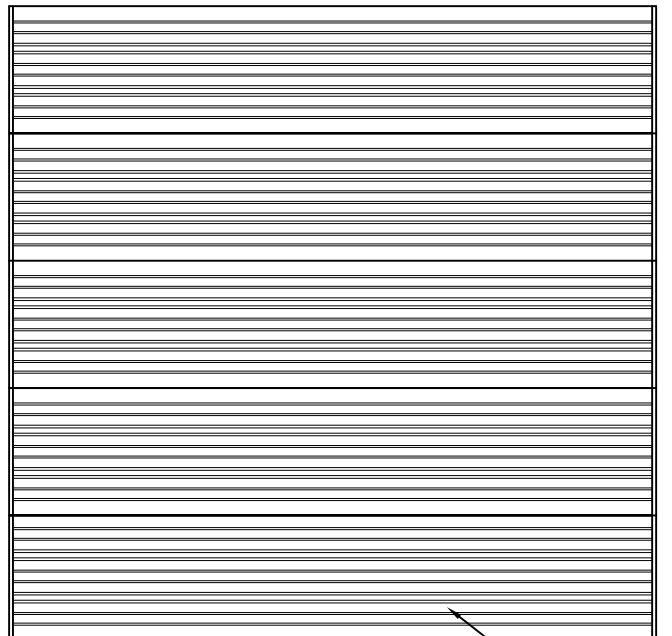

EXTERIOR ELEVATION

Nominal 24 Gauge
Exterior Skin

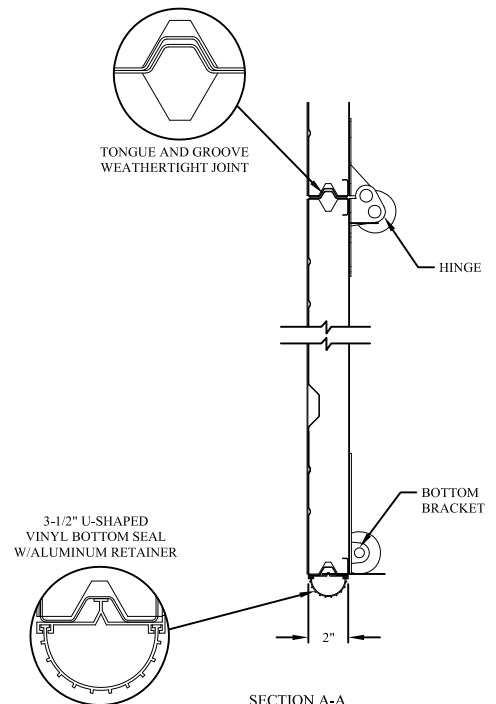

SECTION A-A

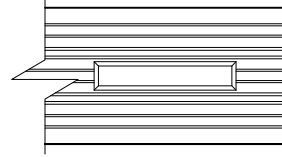
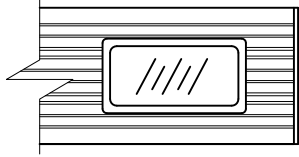

24" x 12" WINDOW W/ NON-INSULATED 1/8" PLEXI-GLASS AND DOUBLE PANE INSULATED PLEXI-GLASS 24" x 4" WINDOW WITH 1/8" PLEXI-GLASS

| DOOR WIDTH | MAX No. WINDOWS |
|------------|-----------------|
| 8'2" | 2 |
| 9'2" | 2 |
| 10'2" | 3 |
| 11'2" | 3 |
| 12'2" | 3 |
| 13'2" | 4 |
| 14'2" | 4 |
| 15'2" | 4 |
| 16'2" | 4 |
| 17'2" | 5 |
| 18'2" | 5 |
| 19'2" | 5 |
| 20'2" | 6 |

NOTE: CHART ABOVE INDICATES MAXIMUM NUMBER OF WINDOWS PER SECTION.

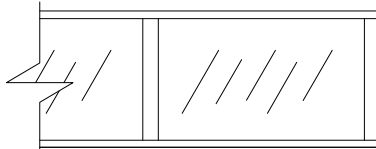

ALUMINUM FULLVIEW SECTION

| DOOR WIDTH | DOOR HEIGHTS | | | | | | | | |
|---------------|--------------|------|------|-------|-------|-------|-------|-------|-------|
| | 7'1" | 8'1" | 9'1" | 10'1" | 11'1" | 12'1" | 13'1" | 14'1" | 16'1" |
| 8'2" - 12'2" | 3 | 3 | 4 | 4 | 5 | 5 | 6 | 6 | 7 |
| 12'4" - 14'2" | 3 | 3 | 4 | 4 | 5 | 5 | 6 | 6 | 7 |
| 14'4" - 16'2" | 3 | 3 | 4 | 4 | 5 | 5 | 6 | 6 | 7 |
| 16'4" - 20'2" | 3 | 3 | 4 | 4 | 5 | 5 | 6 | 6 | 7 |

NOTE: CHART ABOVE INDICATES MAXIMUM NUMBER OF ALUMINUM FULLVIEW SECTIONS PER DOOR SIZE.

*FOR INSULATED GLASS CONFIGURATION CONTACT ENGINEERING

| DOOR WIDTH | MIN. No. PANELS |
|------------|-----------------|
| 8'2" | 2 |
| 9'2" | 2 |
| 10'2" | 3 |
| 11'2" | 3 |
| 12'2" | 3 |
| 13'2" | 4 |
| 14'2" | 4 |
| 15'2" | 4 |
| 16'2" | 4 |
| 17'2" | 5 |
| 18'2" | 5 |
| 19'2" | 5 |
| 20'2" | 6 |

NOTE: CHART ABOVE INDICATES MINIMUM NUMBER OF PANELS PER SECTION.

SECTION ARRANGEMENT CHART

| Door Height | 21" Bottom | 21" Intermediate | 24" Bottom | 24" Intermediate |
|--------------------|-------------------|-------------------------|-------------------|-------------------------|
| 7'0" | 1 | 3 | | |
| 7'3" | | 3 | 1 | |
| 7'6" | | 2 | 1 | 1 |
| 7'9" | | 1 | 1 | 2 |
| 8'0" | | | | 4 |
| 8'3" | Not Available | | | |
| 8'6" | Not Available | | | |
| 8'9" | 1 | 4 | | |
| 9'0" | | 4 | 1 | |
| 9'3" | | 3 | 1 | 1 |
| 9'6" | | 2 | 1 | 2 |
| 9'9" | | 1 | 1 | 3 |
| 10'0" | | | 1 | 4 |
| 10'3" | Not Available | | | |
| 10'6" | 1 | 5 | | |
| 10'9" | | 5 | 1 | |
| 11'0" | | 4 | 1 | 1 |
| 11'3" | | 3 | 1 | 2 |
| 11'6" | | 2 | 1 | 3 |
| 11'9" | | 1 | 1 | 4 |
| 12'0" | | | 1 | 5 |
| 12'3" | 1 | 6 | | |
| 12'6" | | 6 | 1 | |
| 12'9" | | 5 | 1 | 1 |
| 13'0" | | 4 | 1 | 2 |
| 13'3" | | 3 | 1 | 3 |
| 13'6" | | 2 | 1 | 4 |
| 13'9" | | 1 | 1 | 5 |
| 14'0" | | | 1 | 6 |
| 14'0" | 1 | 7 | | |
| 14'3" | | 7 | 1 | |
| 14'6" | | 6 | 1 | 1 |
| 14'9" | | 5 | 1 | 2 |
| 15'0" | | 4 | 1 | 3 |
| 15'3" | | 3 | 1 | 4 |
| 15'6" | | 2 | 1 | 5 |
| 15'9" | | 1 | 1 | 6 |
| 15'9" | 1 | 8 | | |
| 16'0" | | | 1 | 7 |
| 16'0" | | 8 | 1 | |