

ENTRE/MATIC

1BRMT and 3BRMT 1 and 3 Button Remote Control

Programming/Operating Instructions

Manufactured by:
GTO Access Systems, LLC
(844) 256-3130
www.gtoaccess.com



DESCRIPTION

The 1 and 3 button remote controls are wireless radio controls designed for use with automatic garage and gate operators.

Each of the remote control buttons will send a unique code when pressed. One button can be used to activate the individual's garage door opener, a second button can operate an access gate, a third button can activate an additional garage door operator.

Remote controls and receivers do not contain a typical "coding switch". Each remote control is permanently coded at the factory. The receiver is programmed by "learning" a remote control's unique digital code. The receiver will activate only from the "memorized" transmitters.

The remote control is powered by a Type CR2032 "coin-cell" battery. The battery should last at least 1 year with normal use. The indicator light on the remote control will glow when the unit is activated. If the indicator lights dimly, or not at all when transmitting, the battery needs to be replaced. To conserve battery life, an internal timer limits the transmission duration to 20 seconds if a remote control button is held down.

- 1 Refer to the instructions provided with the garage door opener to set it into "learn" mode.
 - Press the opener's LEARN BUTTON for 1 second and release.
 - The opener should BEEP and the LIGHT should BLINK once.
 - The RED LED will remain lit in Learn Mode for 15 seconds.
- 2 While the RED LED is lit, PRESS and HOLD the desired remote control button until the opener BEEPS and the RED LED BLINKS once.

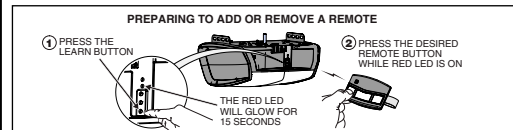

After programming, test the remote control from various locations. **Be sure the door or gate areas are clear.** Activate the remote control and verify that the remote control triggers the operator(s).

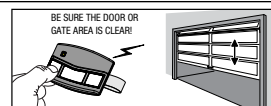

VISOR CLIP INSTALLATION

The visor clip can be installed for horizontal or vertical mounting. Slide the visor clip into one of the slots shown.

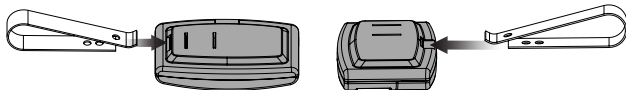

LIMITED WARRANTY

This product is warranted to the consumer against defects in material and workmanship for one year from the date of purchase. This warranty applies to first retail buyers of new devices. Manufacturer will repair, or at its option, replace, any device it finds that requires service under this warranty, and will return the repaired or replaced device to the consumer at the manufacturer's cost. For warranty service and shipping instructions contact manufacturer at the address shown below. Devices must be sent to manufacturer for service at owner's expense. The remedies provided by this warranty are exclusive. Implied warranties under state law are to the one year period of this written warranty. Some states do not allow limitations on how long an implied warranty lasts, so the above limitation may not apply to you. In order to be protected by this warranty, save your proof of purchase and send copy with equipment should repair be required. This warranty gives you specific legal rights, and you may also have other rights which vary from state to state.

All products returned for warranty service require a Return Product Authorization Number (RPA#). Contact Technical Service at (844) 256-3130 for an RPA# and other important details.

REPLACING THE BATTERY

When the indicator light on the remote glows dimly, or fails to light at all when the remote control is activated, the battery needs replacing.

Follow the steps in the diagram and use caution to keep batteries away from children.

Replace old battery with a new CR2032 Lithium battery.

Properly dispose of old batteries. Many electronic stores and supermarkets have battery recycling bins.

Never dispose of batteries in fire because they could explode.

REPLACING THE REMOTE CONTROL BATTERY

- 1 USE VISOR CLIP IN SLOT TO OPEN CASE
- 2 LIFT OFF TOP OF CASE
- 3 CAREFULLY REMOVE THE BOARD



NOTE: The circuit board only fits one way into the case. Align the plastic post in the case with the hole in the circuit board.



WARNING

KEEP BATTERIES OUT REACH OF CHILDREN. Swallowing batteries can lead to serious injury or death. If you suspect someone has swallowed a battery, go to the hospital immediately. Do not induce vomiting or eat or drink anything.

For more information, call the National Battery Ingestion Hotline: 202-625-3333.

The battery identification number for this product is CR2032.

IMPORTANT !!!

Entrematic radio controls provide a reliable communications link and fill an important need in portable wireless signaling. However, there are some limitations which must be observed.

- For U.S. installations only: The radios are required to comply with FCC Rules and Regulations as Part 15 devices. As such, they have limited transmitter power and therefore limited range.
- A receiver cannot respond to more than one transmitted signal at a time and may be blocked by radio signals that occur on or near their operating frequencies, regardless of code settings.
- Changes or modifications to the device may void FCC compliance.
- Infrequently used radio links should be tested regularly to protect against undetected interference or fault.
- A general knowledge of radio and its vagaries should be gained prior to acting as a wholesale distributor or dealer, and these facts should be communicated to the ultimate users.

WARNING: Changes, modifications or adjustments not expressly approved by manufacturer could void the user's authority to operate this equipment. There Are No User Serviceable Parts.

NOTICE: This device complies with part 15 of the FCC rules and with Industry Canada license-exempt RSS standard(s). Operation is subject to the following two conditions: (1) this device may not cause interference, and (2) this device must accept any interference, including interference that may cause undesired operation of the device.

Le présent appareil est conforme aux CNR d'Industrie Canada applicables aux appareils radio exempts de licence. L'exploitation est autorisée aux deux conditions suivantes : (1) l'appareil ne doit pas produire de brouillage, et (2) l'utilisateur de l'appareil doit accepter tout brouillage radioélectrique subi, même si le brouillage est susceptible d'en compromettre le fonctionnement.