

# HIGH LIFT STANDARD TRACK SET DETAIL 3" TAPERED REVERSE ANGLE MOUNT

**ENTRE//MATIC**

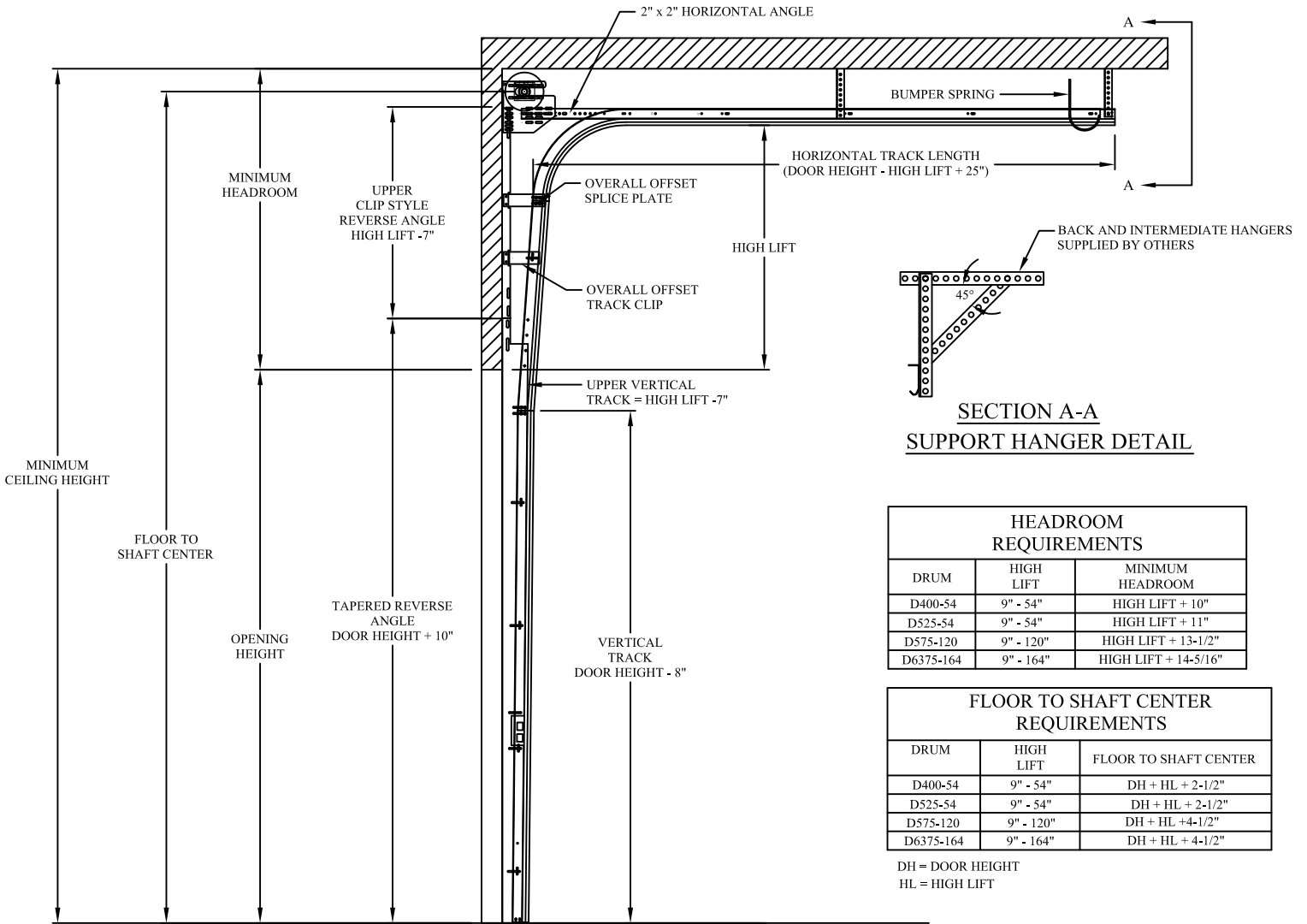

HEADROOM REQUIREMENTS		
DRUM	HIGH LIFT	MINIMUM HEADROOM
D400-54	9" - 54"	HIGH LIFT + 10"
D525-54	9" - 54"	HIGH LIFT + 11"
D575-120	9" - 120"	HIGH LIFT + 13-1/2"
D6375-164	9" - 164"	HIGH LIFT + 14-5/16"

FLOOR TO SHAFT CENTER REQUIREMENTS		
DRUM	HIGH LIFT	FLOOR TO SHAFT CENTER
D400-54	9" - 54"	DH + HL + 2-1/2"
D525-54	9" - 54"	DH + HL + 2-1/2"
D575-120	9" - 120"	DH + HL + 4-1/2"
D6375-164	9" - 164"	DH + HL + 4-1/2"

DH = DOOR HEIGHT  
HL = HIGH LIFT

HIGH LIFT STANDARD TAPERED REVERSE ANGLE MOUNT TRACK SET DETAIL